

POWERFLEX®

PART NUMBER

PFF5-1405

DESCRIPTION

FRONT UPPER WISHBONE BUSH

INSTALLATION GUIDE (PAGE 1 OF 2)

Contents (parts per pack):

4 X Polyurethane Bushes	4 X Stainless Steel Sleeves
4 X Zinc Plated Outer Shells	2 X Plastic Fitting Collar
4 X Washers	1 x PTFE/Silicone Grease

Please read the complete fitting instructions and check package components before fitment. These fitting instructions are to be used as a guide and in conjunction with workshop manual.

It is recommended that:

- all work to be carried out by a licensed technician;
- all safety precautions adhered to;
- wheel alignment to be checked and adjusted as required after any suspension work.
- All fasteners must be tensioned to manufacturer's torque settings.

Fitting Instructions:

1. Remove the original bush from the arm and clean any sharp edges or burrs from the bore of the arm using a rounded file.
2. For the front-facing bush, press the zinc-plated outer shell into the vacant hole from the outside of the arm until the lip of the shell sits flush on the flat surface of the arm.
3. For the rear-facing bush, place the plastic fitting collar onto the body of the zinc-plated outer shell, so the flat face of the collar is sat against the lip of the shell.
4. Once this is complete, press the shell with the collar into the vacant hole of the arm, matching the collar shape with the contour of the arm.

Note: Refer to Figure 1 to see the final assembled bush with the collar in place. This collar is required to achieve the correct offset for the part. Once the shell is pressed into the arm, the collar cannot be moved.

5. Press the polyurethane bushes into the outer shells from the outside of the arm, paying attention to their position shown on page 2.

6. Apply the supplied grease to the knurled bore of the polyurethane bushes, and insert the stainless steel sleeves until flush with the bush end faces.

7. Place the stainless steel washer on the inner face of each bush.

8. Refit the arm to the vehicle and tension all hardware to the manufacturer recommended torque settings.

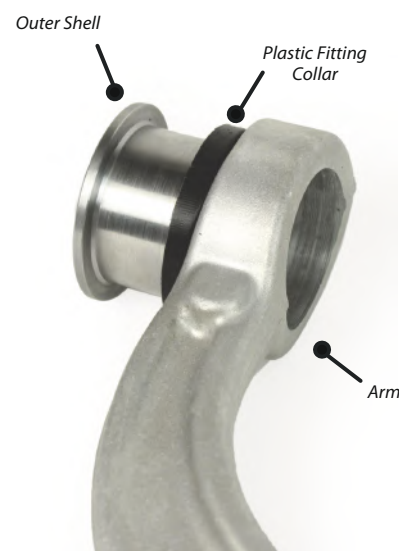

Figure 1 - Orientation of Fitting Collar, for pressing the Rear Bush



Figure 2 - Fully pressed rear Outer Shell

**FRONT OF
CAR**

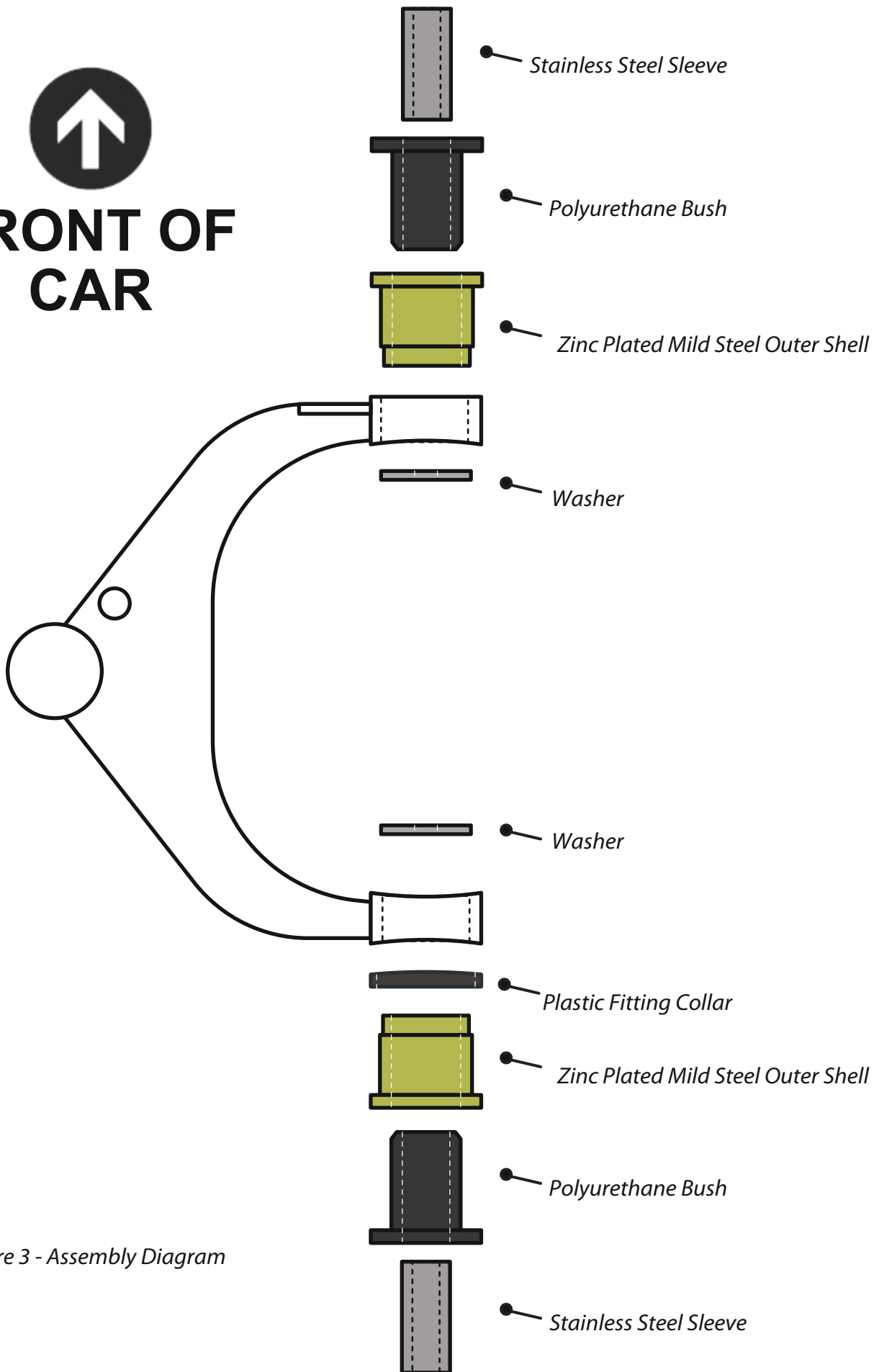

Figure 3 - Assembly Diagram