

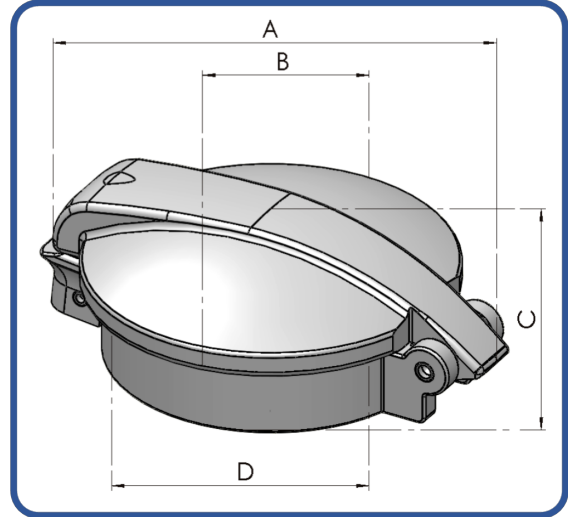

# Classic 200

## Classic 200 Fuel Filler Cap. Part Number: OI-ZA-001 (C20D)



### **Specifications:**

**Options:**  
**Fixing Arrangement:**  
**Applications:**  
**Compatibilities:**

**Finish:**  
**Weight:**  
**Supplied With:**

N/A  
2" x 18TPI WHIT FORM Thread  
Fuel, Oil & Water Tanks  
Compatible with Add Blue  
Operation Temperature -40°C to +80°C  
Natural Polished  
115.0 grams  
Fibre Gasket

### **Materials:**

**Centre Cap:**  
**Flange:**  
**O-Ring:**  
**Seal Plate:**  
**Gasket:**

Aluminium Alloy LM25 Cast  
Aluminium Alloy LM25 Cast  
Viton A (FPM or FKM)  
Brass  
Fibre Vulcan

### **Dimensions:**

**Length A:**  
**Width B:**  
**Height C:**  
**Thread D:**  
**Bore Diameter:**

80.0mm  
46.0mm  
63.5mm  
32.0mm Adjustable  
35.50mm

### **Optional('s):**

**Colour('s):**

Flange  
Flange Neck

***Fluid Containment – When It Matters***

Tell: +4420 8594 7990 / Fax: +4420 8594 7989 / [www.newton-equipment.com](http://www.newton-equipment.com) / [info@newton-equipment.com](mailto:info@newton-equipment.com)  
Registered in England. 6 Orwell Close/ Fairview Ind. Park/ Rainham/ Essex/ RM13 8UB